



NextMove  
LETTINGS

**Grenfell Road**  
Maidenhead, SL6 1FG  
**£1,350 PCM**





## Features

- Superb one bedroom apartment
- Spacious living/dining room
- Fitted kitchen with integrated appliances
- Fitted bathroom
- Close to station and town centre
- Outside Patio with garden furniture
- Double bedroom with fitted wardrobes
- Secure parking available

## Description

A superb apartment situated in a convenient location within two minutes walk of the station, town centre and is close to the River Thames with the benefit of secure underground parking and outside patio area with garden furniture. The property is finished to a high standard, and decorated throughout. Accommodation comprises spacious lounge/dining room with patio doors to garden, fitted kitchen with built-in appliances, double bedroom with king size bed and range of fitted wardrobes, hallway with storage cupboard, and fitted bathroom. The property is offered furnished.

Maidenhead is a popular Town Centre with a wealth of local amenities to include shopping facilities, restaurants, cafes and numerous sport centres. Maidenhead railway station provides mainline services directly to London and via the Elizabeth line.

## Further Details

- Available
- Council Tax band C
- EPC rating D
- No pets

## Floor Plan

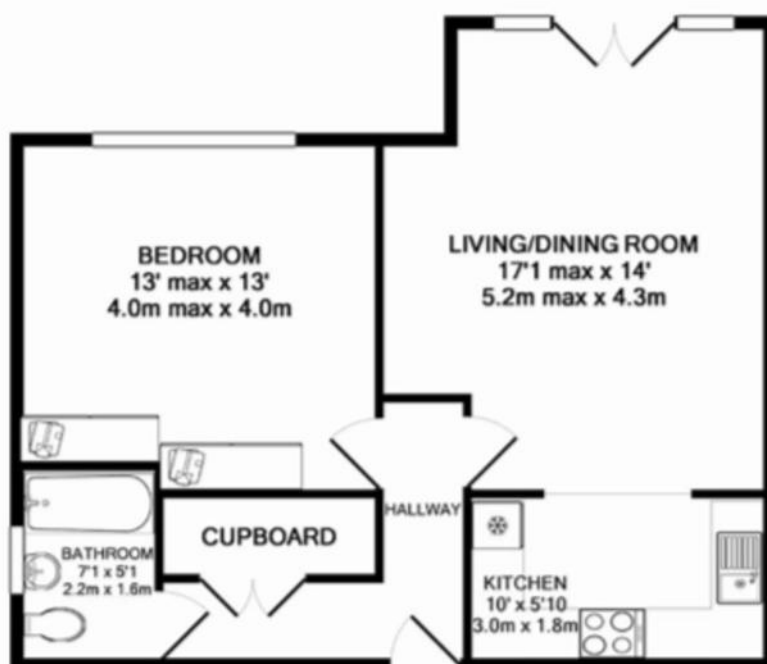

TOTAL APPROX. FLOOR AREA 552 SQ.FT. (51.3 SQ.M.)