



NextMove  
LETTINGS

**Litton Court**

Loudwater, HP10 9RZ

£997 PCM





## Features

- Superb top floor apartment
- Fitted kitchen
- Gas central heating
- Communal Gardens
- Spacious living/dining room
- Double bedroom with balcony
- Double glazing
- Allocated parking

## Description

A superb one bedroom top floor apartment in excellent order throughout. The property comprises; spacious living/dining room, fitted kitchen, double bedroom with balcony, bathroom with shower. Further benefits include gas central heating, double glazing and wood laminate flooring, Outside there are communal gardens. There is allocated and visitors parking. The property is offered unfurnished.

## Further Details

- EPC Rating C
- Council Tax Band C
- Available
- No Pets

## Floor Plan

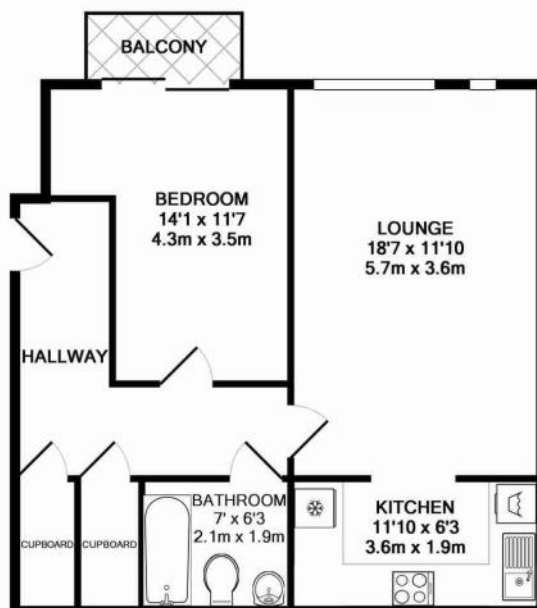

TOTAL APPROX. FLOOR AREA 607 SQ.FT. (56.4 SQ.M.)

Whilst every attempt has been made to ensure the accuracy of the floor plan contained here, measurements of doors, windows, rooms and any other items are approximate and no responsibility is taken for any error, omission, or mis-statement. This plan is for illustrative purposes only and should be used as such by any prospective purchaser. The services, systems and appliances shown have not been tested and no guarantee as to their operability or efficiency can be given.  
Made with Metropix ©2012